

开关功能 Option Of Switch Function



R415KKFT0F

Item No	POLES & THROWS	Rocker position ():Momentary		
		Left	Center	Right
R41	SPST	ON	None	OFF
R42	SPDT	ON	None	ON
R43	SPDT	ON	OFF	ON
R44	SPDT	ON	None	(ON)
R45	SPST	OFF	None	(ON)
R46	SPDT	(ON)	OFF	(ON)
R47	SPST	ON	None	(OFF)
R48	SPDT	ON	OFF	(ON)
R49	SPST (WITHLAMP)	ON	None	OFF

外形尺寸 Dimension

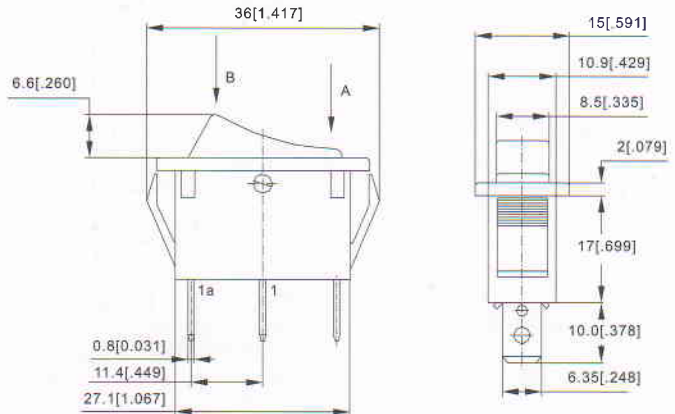
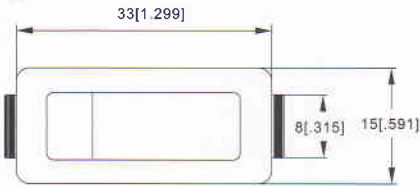

另外还有低脚端子，带直流3V,6V,12V,24V灯等

开孔尺寸 Panel Cut Out

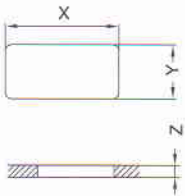

Z	Y	X
0.70~1.25	11.10~11.20	29.60~29.70
1.25~2.00	11.10~11.20	30.10~30.20
2.00~3.00	11.10~11.20	30.45~30.55



R425KRET0FA



R435WWBT0F



R495KMFT2F



R495KYFT2F



R495KDEFT2F